

SAFETY POSTER INSTRUCTIONS FOR THE SAFE HANDLING OF YOUR CUTTING TOOL

martor

SECUNORM 175

Automatic blade retraction
for a high degree of safety

Ergonomic handle
for greater efficiency

Blade-change button
for a safe and easy blade change



Ribbed slider
for a better grip

4-times usable blade
for more durability

Rounded handle end
protects the palm of your hand

Please note: to ensure your product always functions flawlessly, regularly remove any build-up of cutting material.

USAGE

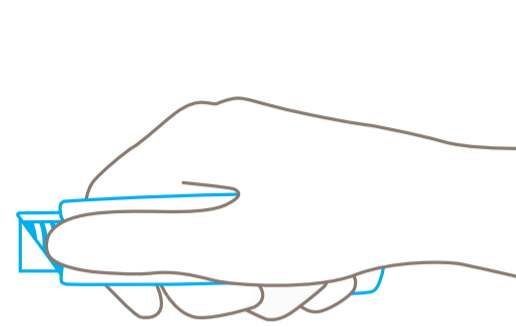

Use the slider to **engage the blade** for cutting.

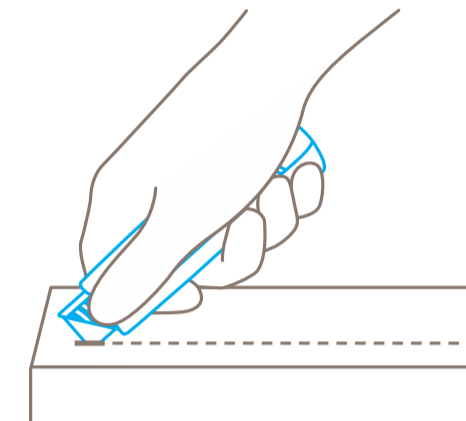

Pierce the cutting material to cut.

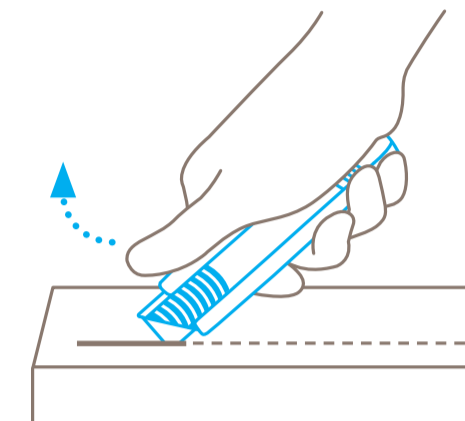

Remove your **thumb from the slider** to ensure automatic blade retraction.

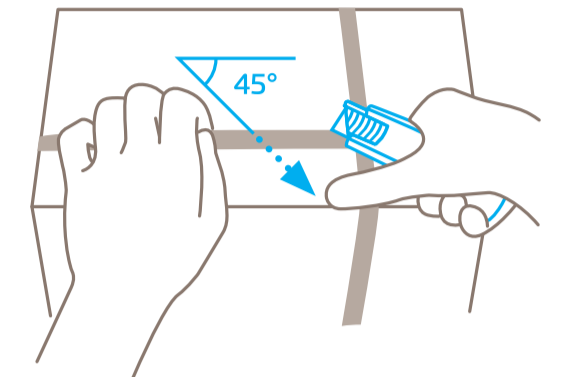

For best results, cut plastic strapping band **diagonally** (at a 45° angle).

BLADE CHANGE

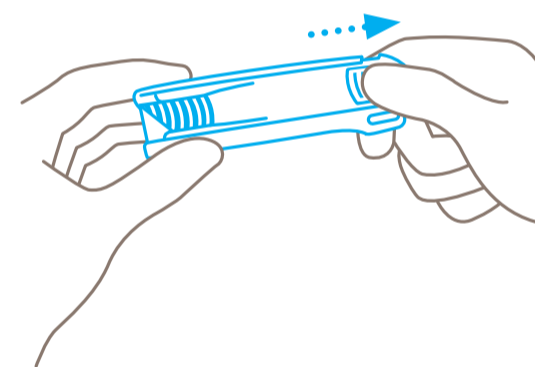

Press the blade-change button and **pull out the plastic insert**.

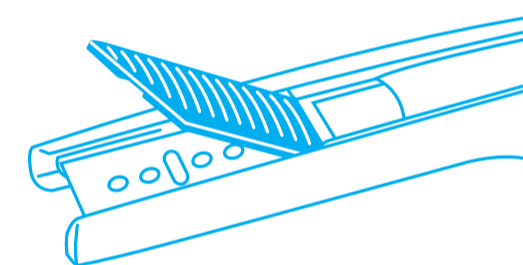

The blade cover opens **automatically**.

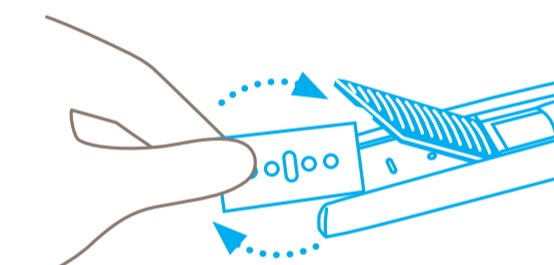

Now you can **turn or change** the blade.

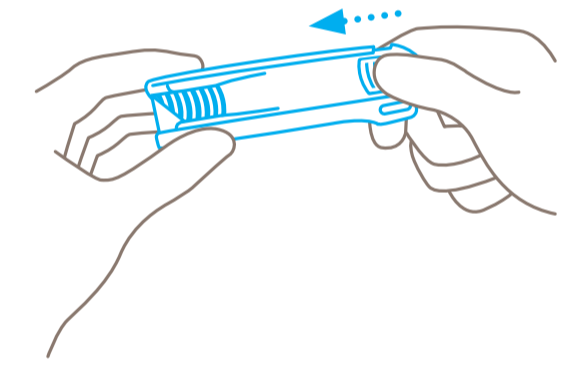

Finally, push the plastic insert back into the handle until you **hear it click into place**.

PROTECTION OF USER

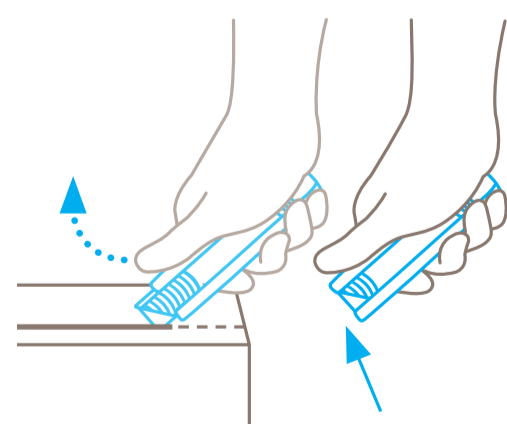

Following cutting, the blade immediately retracts into the handle. Condition: you have **released hold of the slider**.

PROTECTION OF GOODS

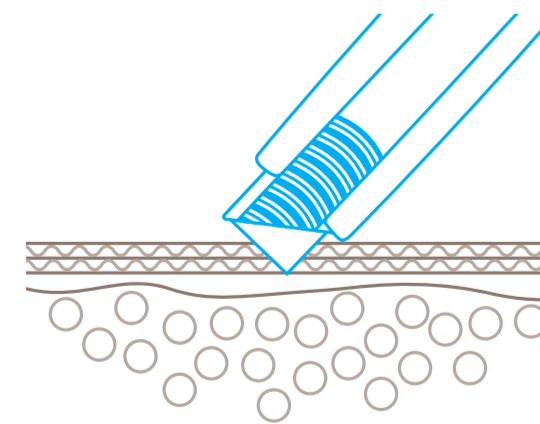

An appropriately **small cutting depth** serves to protect your goods.

DISPOSAL

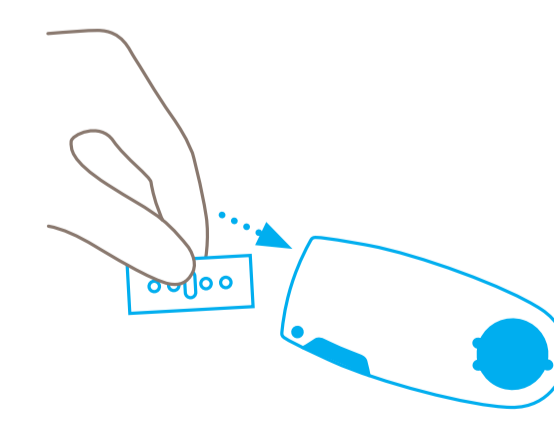

Your **SAFEBOX** is the best place to store **used blades**.

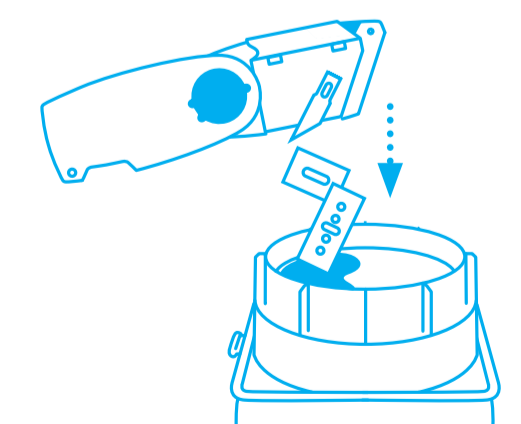

When the **SAFEBOX** is full, **empty all contents** into your **RECYCLING BOX**.